

TCC-160 LAMINATOR PARTS MANUAL

DRAWING NO	PART NO	DESCRIPTION	DRAWING NO	PART NO	DESCRIPTION
001	3LM-B1	PANEL	027	1LM-D18	HEAT PLATE
002	3LM-B2	GEAR	028	3LM-D19	SUPPORT PLATE
003	3LM-B3	BUSH	029	3LM-D20	AXLE
004	3LM-B4	GEAR	030	3LM-D21	TRANS AXILE
004-1	3LM-B4-1	GEAR	031	1LM-D22	FIXED PLATE
005	1LM-B5	ROLLER	032	3LM-D23	PAD
006	1LM-B5-1	ROLLER	033	3LM-D24	SPRING
007	1LM-B6	ROLLER	034	3LM-D25	SPRING
008	3LM-B7	KNOB	035	3LM-D26	SPRING PAD
009	B-9	RUBBER FOOT	035-1	3LM-D27	DEPRESS PLATE
009-1	1LM-B10	MARK	035-2	3LM-D27	FIXED PLATE
010	1LM-D1	BASE PLATE	036	1LM-P1	HEATER
018	1LM-D9	REAR PLATE	037	1LM-P2	HEAT-RESIST FORM
019	1LM-D10	REAR DEPRESS PLATE	039	3LM-P4	SOCKET
020	3LM-D11	BRACKET (L)	040	3LM-P5	POWER CORD
021	3LM-D12	BRACKET (R)	041	2LM-P6	POLE SHADE MOTOR
022	3LM-D13	HOOK PLATE (R)	042	3LM-P7	FUSE
023	3LM-D14	HOOK PLATE (L)	043	3LM-P8	SWITCH
024	3LM-D15	MOTOR RACK	044	3LM-P9	SENSOR
025	3LM-D16	POWER RACK			
026	1LM-D17	HEAT-RESIST PLATE			

TCC-230 LAMINATOR PARTS MANUAL

DRAWING NO	PART NO	DESCRIPTION	DRAWING NO	PART NO	DESCRIPTION
001	3LM-B1	PANEL	027	2LM-D18	HEAT PLATE
002	3LM-B2	GEAR	028	3LM-D19	SUPPORT PLATE
003	3LM-B3	BUSH	029	3LM-D20	AXLE
004	3LM-B4	GEAR	030	3LM-D21	TRANS AXILE
004-1	3LM-B4-1	GEAR	031	2LM-D22	FIXED PLATE
005	2LM-B5	ROLLER	032	3LM-D23	PAD
006	2LM-B5-1	ROLLER	033	3LM-D24	SPRING
007	2LM-B6	ROLLER	034	3LM-D25	SPRING
008	3LM-B7	KNOB	035	3LM-D26	SPRING PAD
009	B-9	RUBBER FOOT	035-1	3LM-D27	DEPRESS PLATE
009-1	2LM-B10	MARK	035-2	3LM-D27	FIXED PLATE
010	2LM-D1	BASE PLATE	036	2LM-P1	HEATER
018	2LM-D9	REAR PLATE	037	2LM-P2	HEAT-RESIST FORM
019	2LM-D10	REAR DEPRESS PLATE	039	3LM-P4	SOCKET
020	3LM-D11	BRACKET (L)	040	3LM-P5	POWER CORD
021	3LM-D12	BRACKET (R)	041	2LM-P6	POLE SHADE MOTOR
022	3LM-D13	HOOK PLATE (R)	042	3LM-P7	FUSE
023	3LM-D14	HOOK PLATE (L)	043	3LM-P8	SWITCH
024	3LM-D15	MOTOR RACK	044	3LM-P9	SENSOR
025	3LM-D16	POWER RACK			
026	2LM-D17	HEAT-RESIST PLATE			

TCC-330 LAMINATOR PARTS MANUAL

DRAWING NO	PART NO	DESCRIPTION	DRAWING NO	PART NO	DESCRIPTION
001	3LM-B1	CONTROL PANEL	029	3LM-D20	AXLE
002	3LM-B2	GEAR	030	3LM-D21	TRANS AXILE
003	3LM-B3	BUSH	031	3LM-D22	FIXED PLATE
004	3LM-B4	GEAR	032	3LM-D23	PAD
004-1	3LM-B4-1	GEAR	033	3LM-D24	SPRING
005	3LM-B5	FRONT ROLLER(LOWER)	034	3LM-D25	SPRING
006	3LM-B5-1	FRONT ROLLER(UPPER)	035	3LM-D26	SPRING PAD
007	3LM-B6	REAR ROLLER	035-1	3LM-D27	DEPRESS PLATE
008	3LM-B7	KNOB	035-2	3LM-D28	FIXED PLATE
009	B-9	FOOT PAD	036	3LM-P1	HEATER
009-1	3LM-B10	MARK	037	3LM-P2	HEAT-RESIST FORM
010	3LM-D1	BASE	038	3LM-P3	PCB
018	3LM-D9	REAR PLATE	039	3LM-P4	SOCKET
019	3LM-D10	REAR DEPRESS PLATE	040	3LM-P5	POWER CORD
020	3LM-D11	BRACKET (L)	041	3LM-P6	POLE SHADE MOTOR
021	3LM-D12	BRACKET (R)	042	3LM-P7	CUT-OFF FUSE
022	3LM-D13	HOOK PLATE (R)	043	3LM-P8	SWITCH
023	3LM-D14	HOOK PLATE (L)	044	3LM-P9	SENSOR
024	3LM-D15	MOTOR RACK	045	3LM-P10	SENSOR WIRE
025	3LM-D16	POWER RACK	046	D226A	WIREA
026	3LM-D17	HEAT-RESIST PLATE	047	D226B	WIREB
027	3LM-D18	HEAT PLATE	048	D226C	WIREC
028	3LM-D19	SUPPORT PLATE	049	D226D	WIRED

TCC-160 LAMINATOR

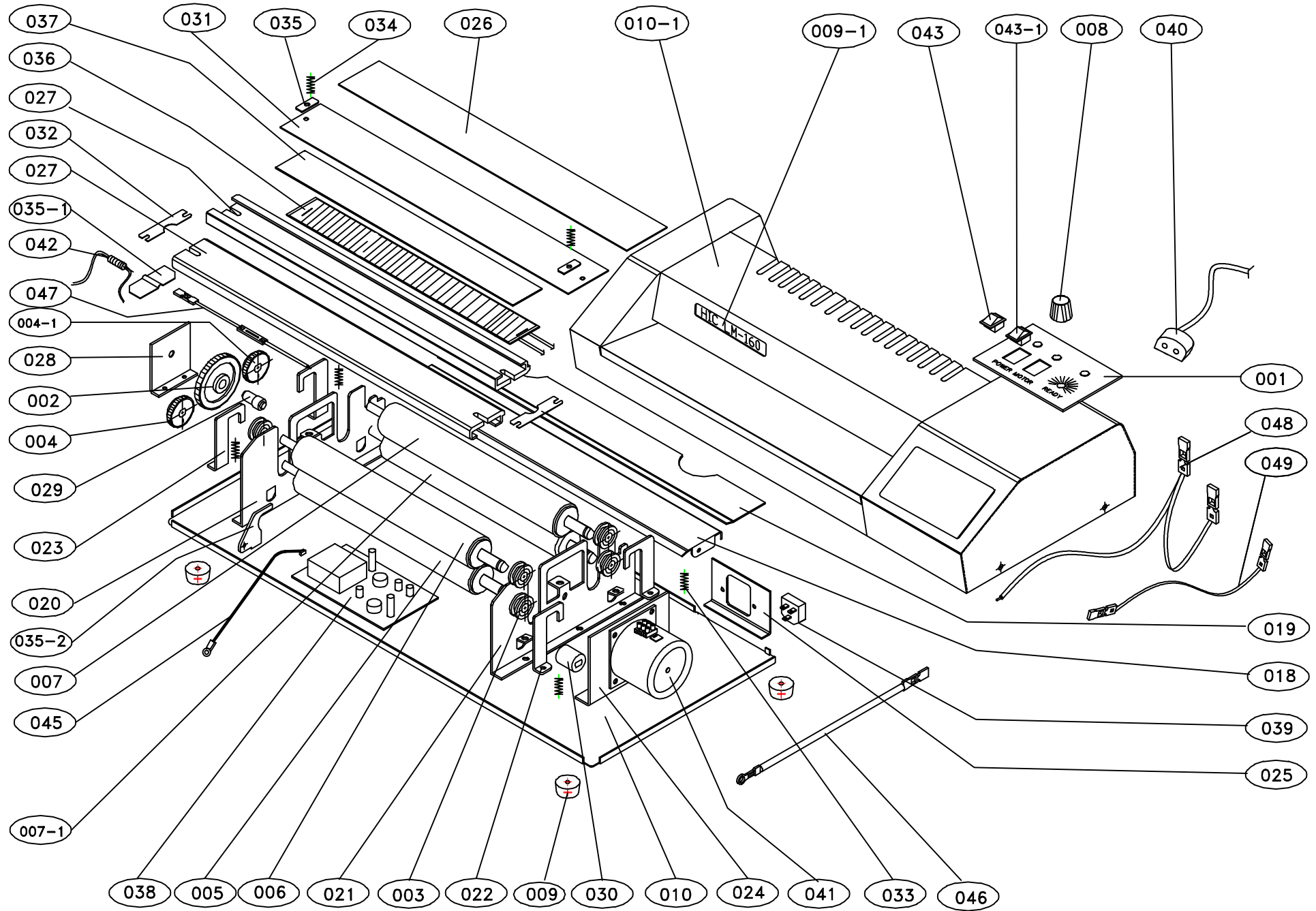

TCC-230 LAMINATOR

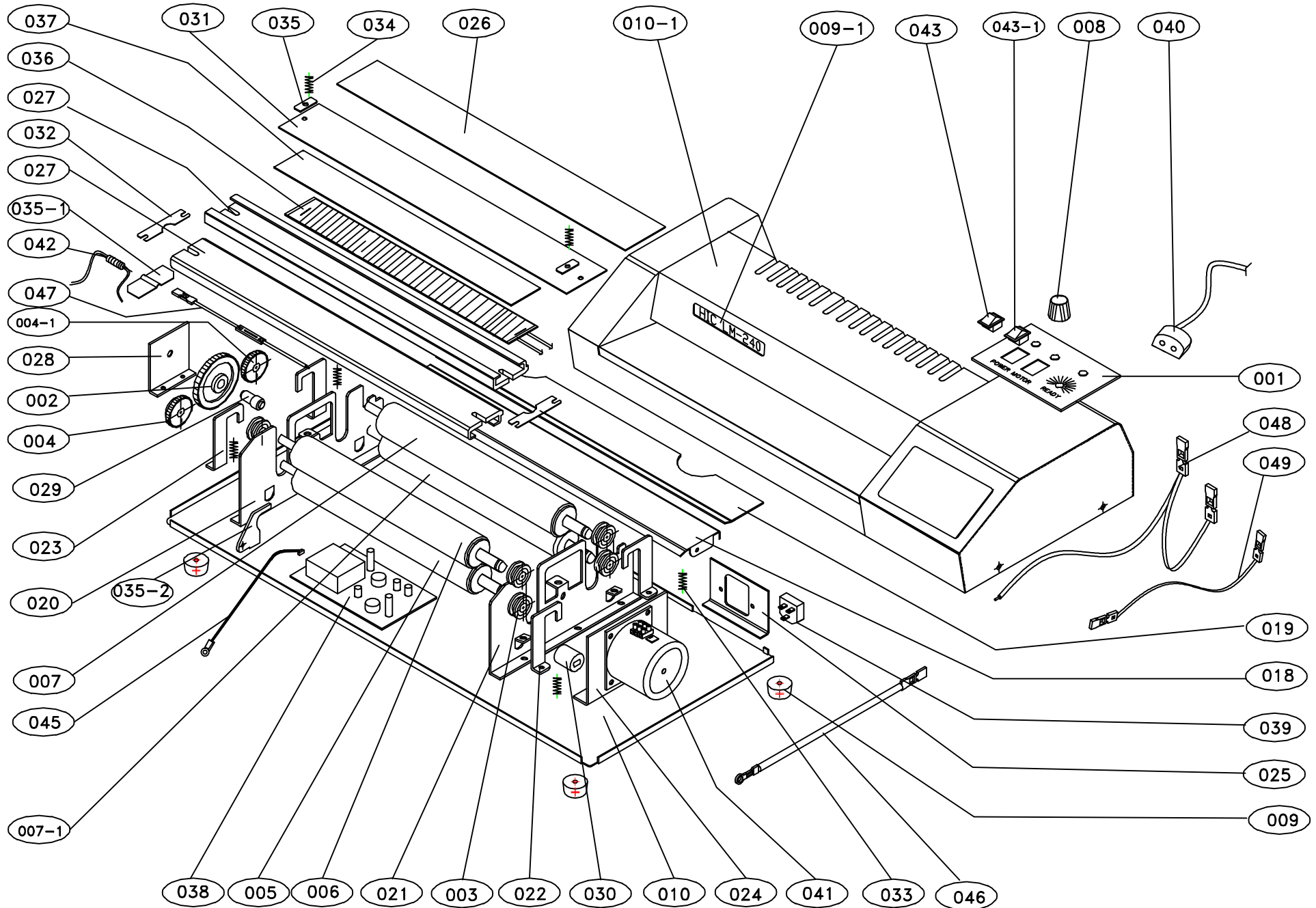

TCC-330 LAMINATOR

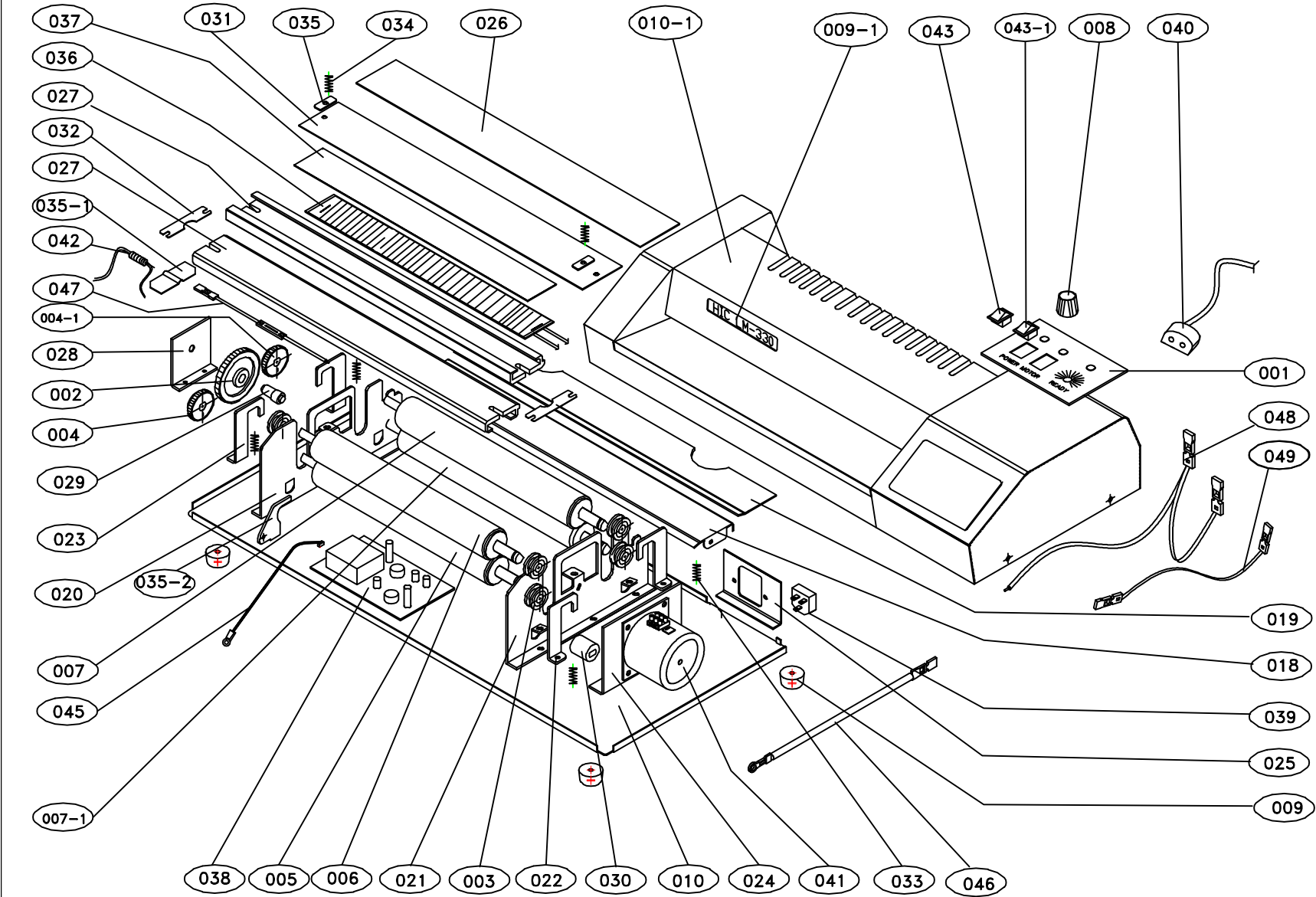

MODIFIED 97.09.30