

User Guide

Version A 05/2015

Mixed Thickness Feeder

20150522

POSTMARK

POSTMARK INC

PHONE | 805.594.1454
FAX | 805.594.1455

3197 DUNCAN LANE #A
SAN LUIS OBISPO, CA 93401
 UNITED STATES OF AMERICA

WWW.POSTMARK-USA.COM

POSTMARK APS

PHONE | +45 66 179833

ENIGHEDSVEJ 21
5000 ODENSE C
 DENMARK

WWW.POSTMARK.DK

Safety Page 2

Before You Start..... Page 3

Packaging Recommendations..... Page 3

Basic Operation..... Page 4

Touchscreen Operation Page 5

Advanced Settings..... Page 6

Feed Settings Page 7

Batch Counter..... Page 8

Statistics Page 8

Feeding and Separation Page 9

Troubleshooting Page 11

Specifications Page 12

Warnings

- Disconnect the power supply before performing any maintenance.
- Before connecting the system to the electrical supply, ensure that the system is suitable for the local mains voltage. Refer to the serial plate on your system for voltage requirements.

Precaution

The general process of automated document handling can sometimes create a build up of static electricity. Therefore we recommend that the following measures are taken to reduce the side effects of any electrostatic charge.

- Make sure that you operate the system within the recommended temperature and humidity conditions.
- Make use of antistatic mats where appropriate.
- If necessary, make use of an ionizer to reduce static charge build up in the room where the system is located.

Please contact your supplier for further information.

Safety Precautions

- Only competent, trained personnel should operate this system. If non-trained personnel do operate this system, the manufacturer will not accept responsibility for any resulting accidents or injuries.
- Only skilled persons, who are aware of the risks involved, may open the protective covers. For safety reasons, the system will not function when the covers are open.
- Keep long hair, fingers, jewelry, etc. away from rotating and moving parts.
- The power connection must be easily accessible, preferably close to the system. For safety reasons, it is essential that the system is connected to a socket outlet that has a protective earth (ground) connection.
- Over current protection in the equipment also relies on the branch circuit protection (max. 20 A).
- The following part(s) is (are) considered the equipment disconnect device(s):
 - Power supply cord plug or appliance coupler.

Country Specific Conditions

Denmark

In Denmark, certain types of Class 1 appliances may be provided with a plug that does not provide an adequate earth (ground) connection when inserted into a Danish socket outlet. Make sure the system has a good functioning connection that has protective earthing (the plug and socket outlet must match).

Japan

- Establish an earth (ground) connection before connecting the mains plug to the power supply.
- First disconnect the power supply before removing the earth (ground) connection.

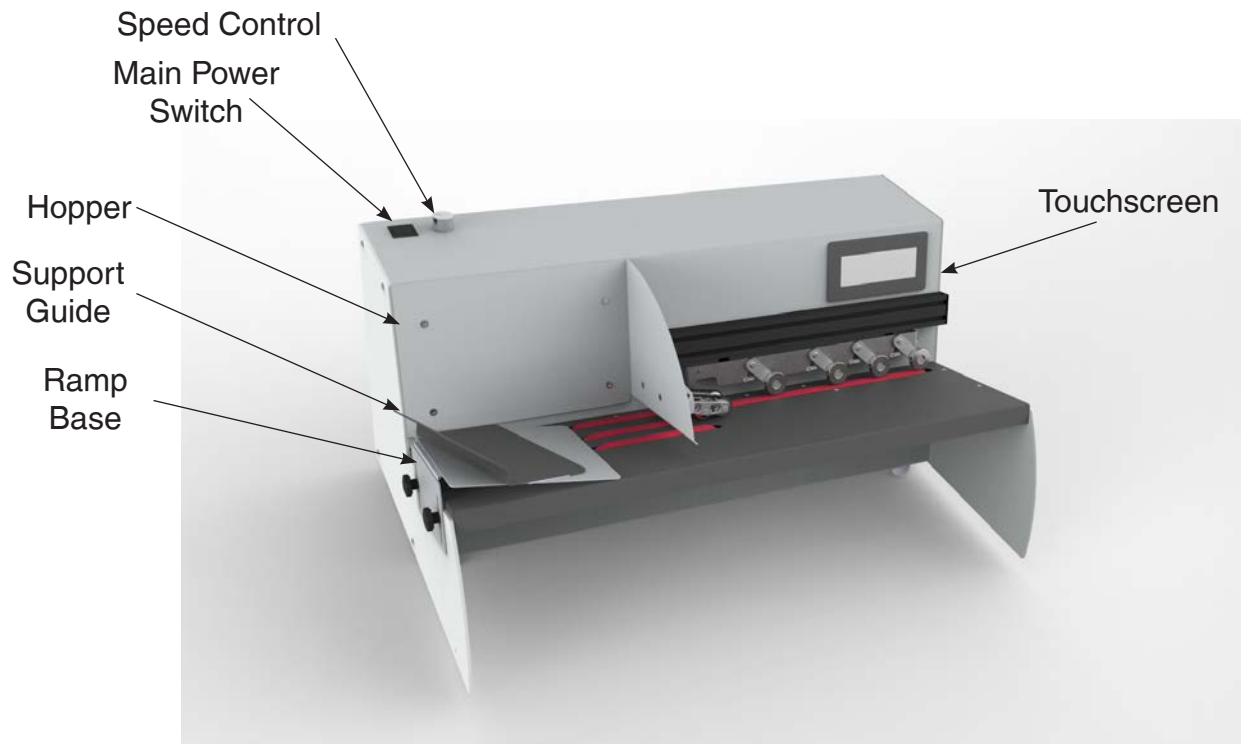

Hopper	Media is loaded here for processing
On/Off	Switch that turns the system on and off
Speed Control	Knob to control the speed of the machine
Touchscreen	Used to start the machine and change feed settings
Separator	Allows only one piece of media through the machine at a time
Support Guide	Helps media feed correctly into separator
Ramp Base	Removes weight of stacked media from belts helping separation

PACKAGING RECOMMENDATIONS

Upon receipt of your Mixed Thickness Feeder (MTF), it is recommended that you keep the original packaging should the machine need to be mailed out for service. If packaging needs to be disposed of please follow local guidelines for recycling and waste disposal.

ON / OFF Switches

Main Power Switch



To Turn the Mixed Thickness Feeder on:

Press down “I” on the main power switch

To Turn the Mixed Thickness Feeder off:

Press down “O” on the main power switch

Variable Speed

The MTF is equipped with variable speed motors to allow the machine to be ran at different speeds.

The variable speed knob is used to control the speed of the machine. The speed of the machine can be controlled from 0-100%.



Variable Speed Knob

To increase the speed of the machine, turn the variable speed knob clockwise.

To decrease the speed of the machine, turn the variable speed knob anti-clockwise.

Using the touch screen

The MTF is equipped with a 115mm touch screen which controls all feeding and transport operations of the machine. The touch screen is used to control and access the following features on the MTF.

Start / Stop
Resettable Counter
Batch Counter
Rate Counter

Lifetime Counter
Motor Run Time
Speed Percentage
On Demand Feeding

On Delay Feeding
Idle Shutoff
Jam Shutoff
Factory Reset

The Home Screen

The home screen is displayed a few seconds after turning on the machine.

The button to start or stop the machine is located on the home screen as well as the resettable counter. The counter will count media as it goes from the Mixed Thickness Feeder to the Mixed Thickness Printer. When the reset button is pressed, the counter value will reset to 0.

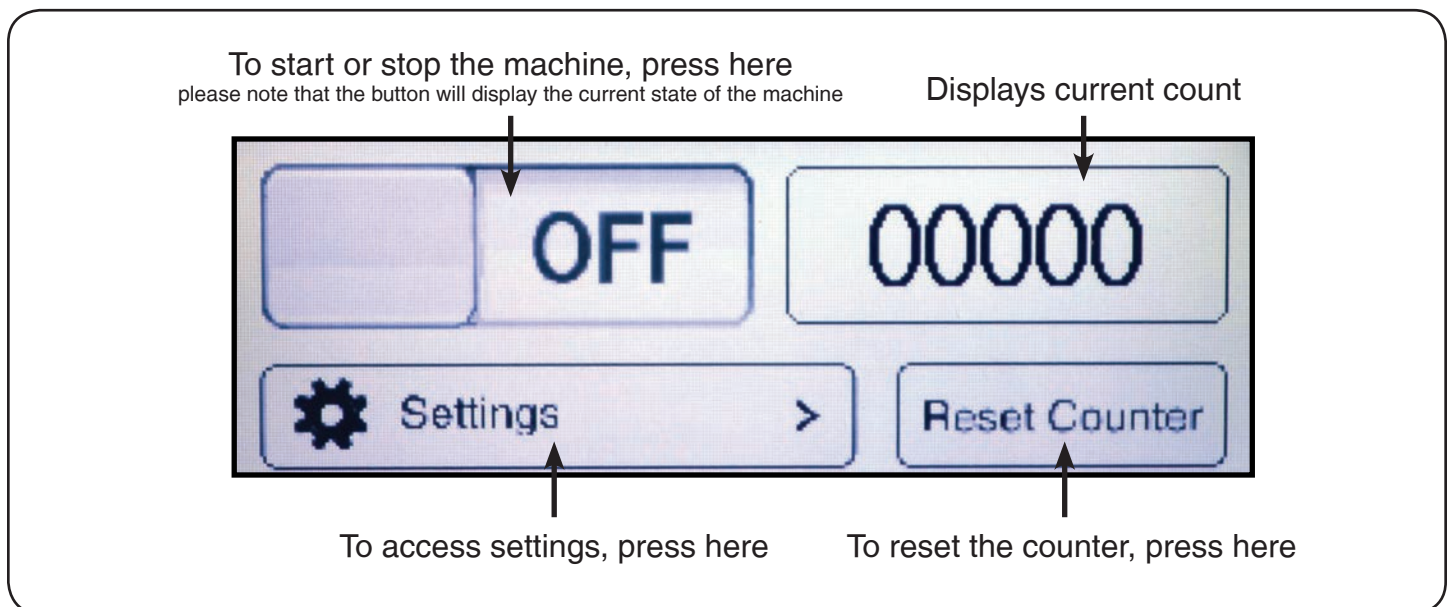

Settings

To access the settings, press the  on the home screen.

There are three pages of settings. To change pages, use the  buttons on the right of the screen.

To return to the home screen, press the  button in the top left corner of the screen.

To access the feed settings menu, press here

To access the batch counter menu, press here

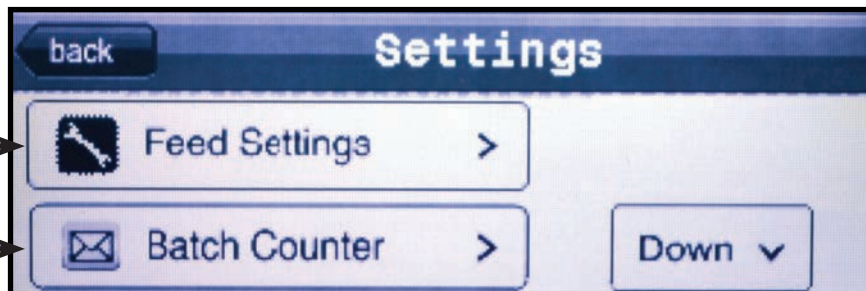

Settings
Page 1

To toggle idle shutoff, press here

To toggle jam shutoff, press here

Idle shutoff and jam shutoff are set on by default factory settings.

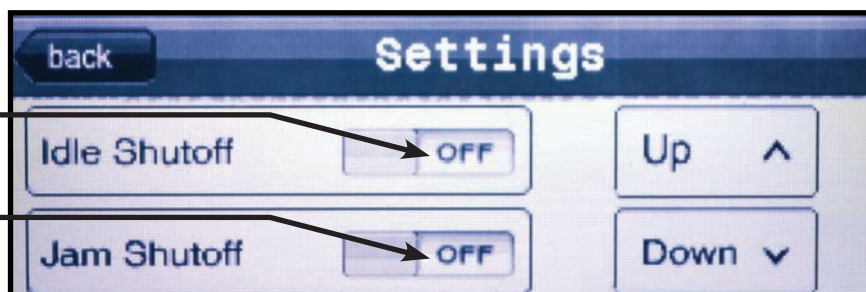

Settings
Page 2

Jam Shutoff will stop the belts only if a jam is detected between the mixed thickness feeder and mixed thickness printer. If a jam occurs elsewhere, the machine will not shutoff with this feature.

Idle Shutoff will stop the belts if the machine has idled without feeding media for more than 1 minute.

To access the statistics menu, press here

To restore software to factory defaults, press here

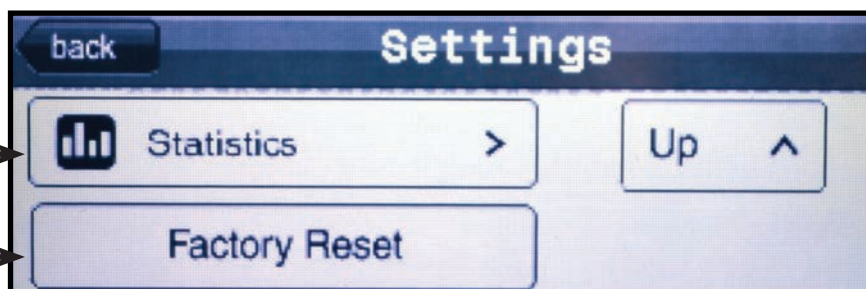

Settings
Page 3

Pressing “Factory Reset” will reset the touchscreen software to factory defaults. Pressing this will not reset any values in the statistics section of the software, only values that can be changed by the operator.

Feed Settings

To access the feed settings, press the  on page one of settings.

Please note that accessing the feed settings menu will stop the machine.

There are three different feed settings which can be used to improve separation and printing quality on the Mixed Thickness Printer

Basic.....media will run continuously through the machine.

On Demandmedia will stop at the end of the feeder and wait for the printer to grab them

On Delay.....media will have a delay in between pieces that can be set in milliseconds

To change feed modes, press the corresponding mode on the below screen. Please note that the current feed mode is highlighted.

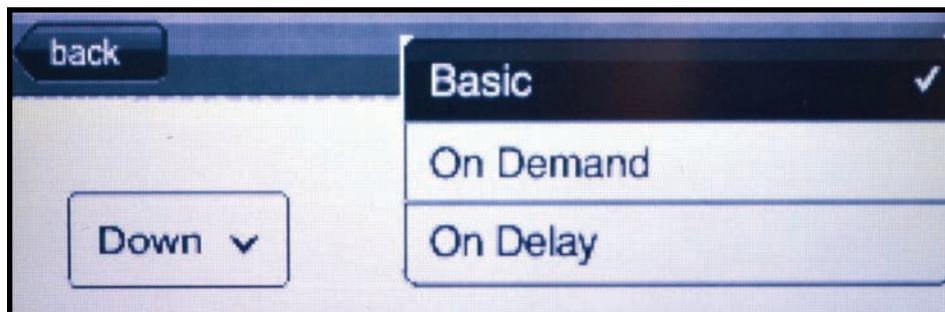

Feed
Settings
Page 1

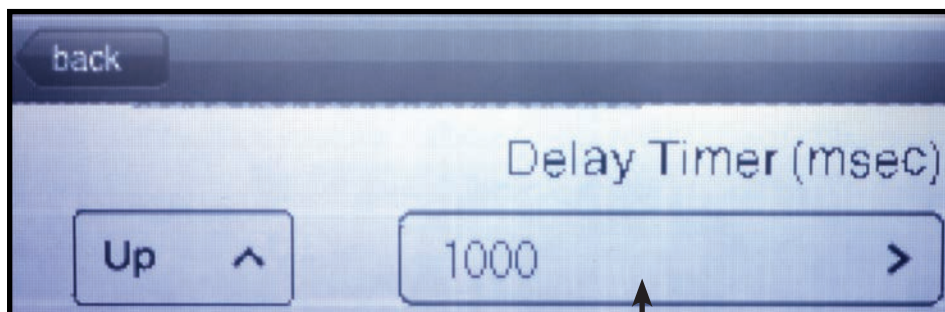

Feed
Settings
Page 2

To change Delay Timer, press here

The On Delay timer can be changed on page 2 of the feed settings in the screen shown above. The value that can be changed is the number of milliseconds between media. If a delay of 1 second is needed between pieces, change the Delay Timer value to 1000. If a delay of 0.5 seconds is needed, change the value of the Delay Timer to 500.

Using the On Delay feed setting is beneficial for greater separation.

Batch Counter

To access the Batch Counter, press the  on page one of settings.

The batch counter is used to stop the machine after a certain number of pieces have been ran through. The number of pieces can be set on the batch counter screen shown below.



To change batch amount
press here

Displays remaining
amount in batch

To Start the machine and batch
counter, press here

Statistics

To access the statistics, press  on page three of settings.

There are four pages of statistics. To change pages, use the  buttons on the right of the screen.

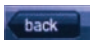
To return to the settings screen, press the  button in the top left corner of the screen.

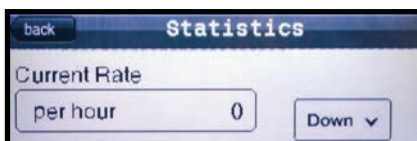

Statistics Page 1

Shows pieces per hour of media currently running through the machine

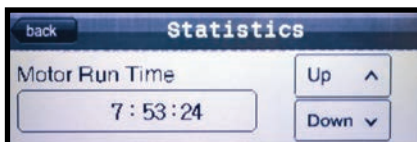

Statistics Page 2

Shows how many hours that the motor has ran inside the machine.

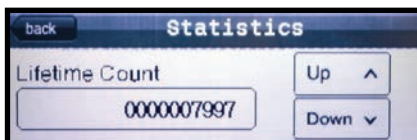

Statistics Page 3

Shows how many pieces of media have been ran through the machine

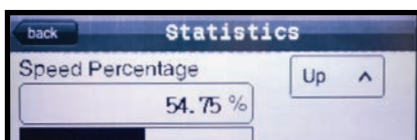

Statistics Page 4

Shows the current speed percentage of motor (from 0-100%)

Mixed Thickness Separator

Media is best fed when sorted by size and thickness. It is recommended to run items more than 6mm (1/4") separately from thinner materials.

The feeder is equipped with a separation mechanism that can be adjusted based on minimum thickness.

To lower the separator, turn the separator knob clockwise.

To raise the separator, turn the separator knob anti-clockwise.

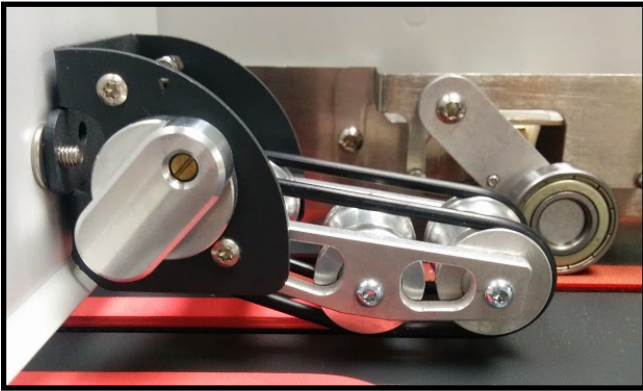

Default Position

Separator belts sit 2mm from the track. Ideal for most envelopes and material up to 8mm in thickness.



Minimum Position

Separator belts sit on track. Recommended for thin items such as postcards or paper.

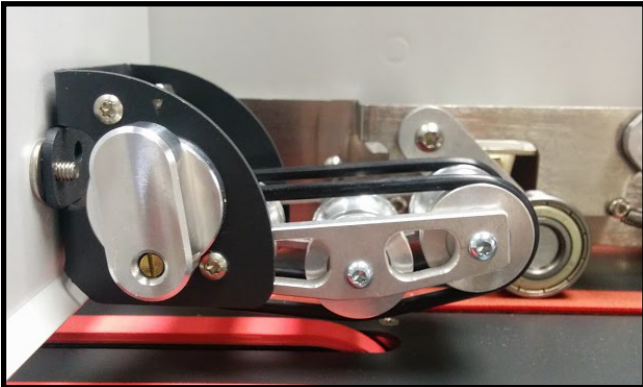

Maximum Position

Separator belts sit 12mm from track. Recommended for media over 8mm in thickness.

Support Guide

The support guide can be used to limit feed hesitation in the feeder. The support guide is magnetic and should be positioned so that the weight of the media is not focused on the belts as shown below.



As shown on the left, only a few envelopes are touching the belts. Using the support guide ensures that the entire weight of the stack of media is not directly positioned on the feed belts.

Also, a slight angle on the support guide can be used to prevent skewing problems.



For large media, move the support guide out to the edge of the feed plate as shown in the picture on the left.

If the machine does not turn on (touchscreen not illuminated), do as follows:

1. Verify that power cord is plugged into the machine and to a valid power source
2. Verify that the main power switch is in the on position ("I" pressed down)
3. Unplug machine and check fuse located in main socket by pulling out on fuse tray

If the machine still does not start, contact your service representative.

Machine turns on (touchscreen illuminated), but belts do not move.

1. Is the start/stop switch on the touchscreen in the "on" position?
2. Is the variable speed knob set the above the 0%?
3. Is the batch counter turned off?
4. Is the machine set to an advanced feed mode?

If the above have been verified, attempt a factory reset and restart machine. If belts still do not move, contact your service representative.

Dimensions: Basic Unit

Length: 711mm (28.0")

Depth: 464mm (18.25")

Height: 330mm (13.0")

Weight: approximately 30kg (67lbs)

Power source: as written on the type label

176-264VAC / 47-63Hz 6.5A (max)

88-132VAC / 47-63Hz 6.5A (max)

Noise Level: Operating - 67dB

Material: Various

Maximum thickness: 12mm (0.47")